

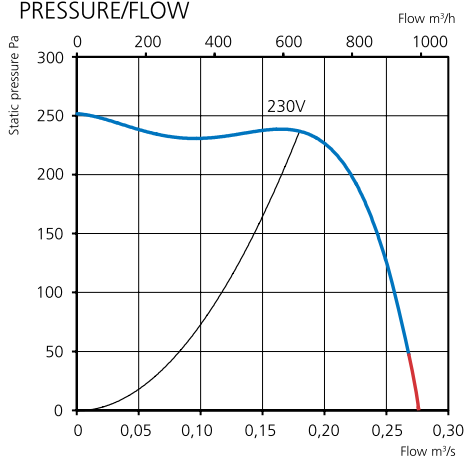

- Single-phase single inlet radial fan.
- Compact with high capacity and efficiency.
- Low sound levels.
- Impeller with forward curved blades.
- The external rotor motor has maintenance-free sealed ball-bearings.
- The motor is situated in the airstream to get ultimate cooling.
- Integrated motor protection.
- Junction box has enclosure class IP 54.
- For speed control a transformer or electronic speed controller can be connected.
- Fan housing is manufactured from galvanized sheet steel.
- Ideal for use in heat exchangers, dehumidifiers and air cleaners.
- Explanations:
KR = With junction box, with connection pipes.
KU = With junction box, without connection pipes.
- All diagrams shown with duct connected fan.

PRESSURE/FLOW



POWER/FLOW

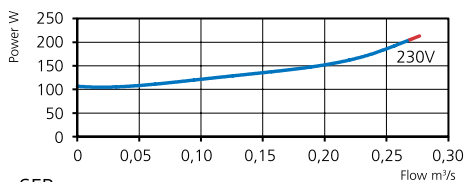

SFP

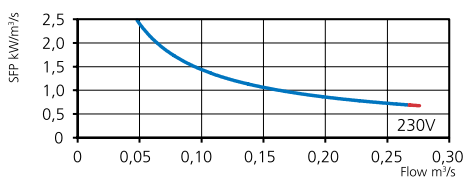

TECHNICAL DATA

Voltage	230 V
Frequency	50 Hz
Phase	1 ~
Current	0.83 A
Power	190 W
Speed	1200 r.p.m.
Max. temp of transported air	50 °C
Sound pressure level, 3 m	57 dB(A)
Weight	6 kg
Enclosure class	44 IP
Wiring diagram	4040001

ACCESSORIES

- Mounting clamp MK 200
- Safety grille BSV 200
- Safety grille BSR 200
- Back draught shutter RSK 200
- Louvre YG 200
- Silencer LDC 200
- Transformer controller VRTE C
- Transformer controller VRDE 1.5
- Speed controller VRS 1.0

SOUND DATA

	L_{wa} tot dB (A)	63	125	250	500	1K	2K	4K	8K
Surrounding 230 V	64	43	47	57	54	58	57	54	46
Outlet 230 V	72	57	58	66	64	67	62	63	57
Inlet 230 V	69	57	60	64	58	61	58	58	50

MORE INFORMATION



Find out the latest updated information about this product by visiting www.ostberg.com or scanning this QR code.

DIMENSIONS

KU

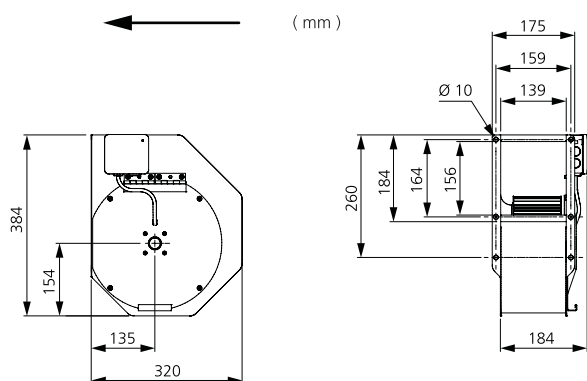

KR

